



WINDEA six

WIND FARM SERVICE VESSEL

GENERAL

Name: Windea six
Flag: German
IMO No: 9841603
Homeport: Borkum
Length o.a.: 27,5 m
Load Line
Length: 23,8 m
Max. Beam: 8,9 m
Max. Draught: 1,6 m
Max. Speed: 28 kn
Service Speed: 26 kn
Deadweight: 30 t
GT/NT: 219 / 65
Cargo Fwd: 2 x 10" or
 1 x20" Container
Cargo Aft: 1 x10"Container

Cargo Deck Area: 81m² Fwd
 31m² Aft

Max. deck Load: 2 t/m²

Crew: 4
Passengers: 24

TECHNICAL SPECIFICATIONS

Main Engines: 4x Scania D16 076M
 (662 kW @2300 RPM)

WaterJets: 4 x Hamilton HM 521
Stabilizer: Humphree Interceptors

Generator: 2 x Cummins Onan
 27 ekW

Deck Crane: 1 x Palfinger PK 23500

Fuel Oil: 35.000 ltr
Fresh Water: 3.000 ltr
Bilge Water: 1.500 ltr

Seats:
 Beurteaux 300 series Executive recliners
 c/w calf rests and foldout single leaf food
 trays and seatbelts.

Entertainment System:
 3 x 32" LED Flat Screens / DVD Player /
 Audiosystem

NAVIGATION & RADIO EQUIPMENT

2 Radars JRC JMA 5212 4BB (ARPA)
Echosounder JMC F-3000W 50khz 1kW
AP70 Autopilot IMO Pack Analog
Hemisphere V103 Satellite Compass
Furuno GP-170 GPS
Navmaster 1000 ECDIS
GMDSS DSC MF/HF Radio Furuno FS1575
2 x Furuno GMDSS VHF Radio with DSC
3 x McMurdo R5 GMDSS portable VHF Radio
EPIRB: McMurdo E5 Smartfinder
SART: McMurdo S4 9GHz Transponder
AIS: CAMINO-701
Navtex: Furuno NX-700A
Magnetic Compass: Ritchie FM 201
Sea Marshall SARfinder 1003-WF-MK3
Sailor 150 Fledbroadband
Radar Reflectors: Echomax Em230BR

OTHER

CCTV

WINDEA six



OUTBOARD PROFILE

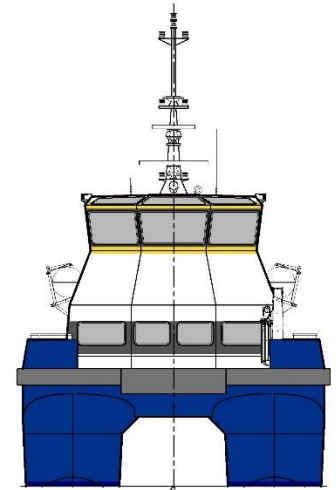

VIEW ON BOW

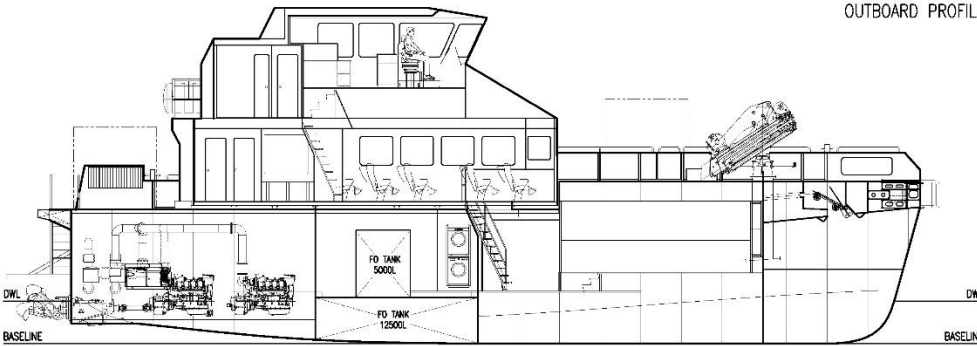

INBOARD PROFILE

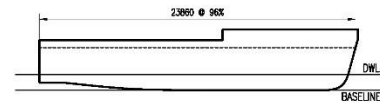

LOAD LINE LENGTH

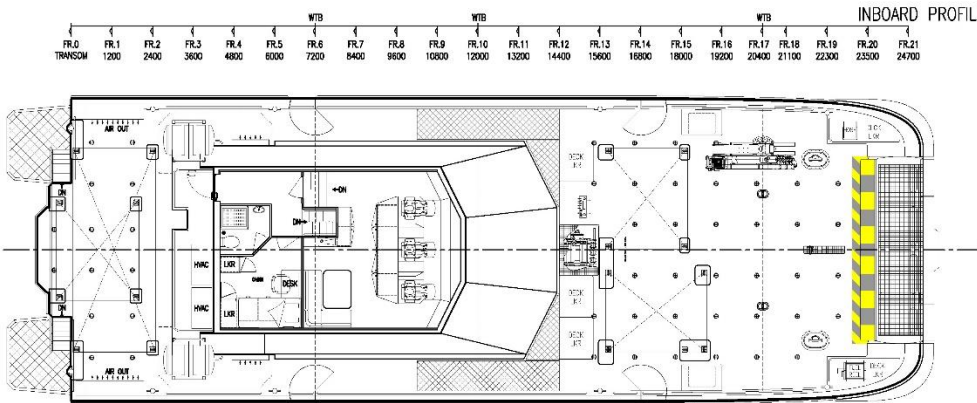

PLAN VIEW BRIDGE

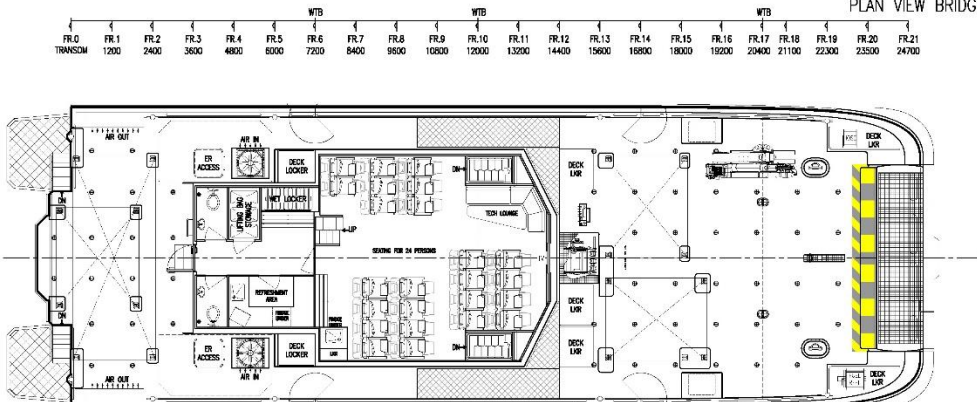

PLAN VIEW ON MAIN DECK

PRINCIPAL PARTICULARS

LENGTH OVERALL:	27.5 m
LOAD LINE LENGTH:	23.8 m
LENGTH WATERLINE (DESIGN):	24.3 m
MAXIMUM MOULDED BEAM:	8.9 m
BEAM DEMIHULL CL - DEMIHULL CL:	5.95 m
HULL DESIGN DRAFT:	1.3 m
HULL SCANTLING DRAFT:	1.6 m
FUEL:	35000 L
FRESH WATER:	2900 L
BLACK WATER:	1500 L
PASSENGER CAPACITY:	24 PAX
CLASS:	LRS- 400A1, SSC, WORKBOAT, CATAMARAN, HSC, G3 MCH

MAX DEADWEIGHT:	30t
AFT CARGO AREA:	31m²
FWD CARGO AREA:	81m²
DECK LOADING:	26m²

MACHINERY / PERFORMANCE

MAIN ENGINES:	4x SCANIA D16 076M 662 kW @ 2300 rpm
WATERJETS:	4x HAMILTON HM521
SPEED @ 100%MCR 10t DWT :	28.0 knts
SPEED @ 85%MCR 10t DWT :	26.0 knts



EMS Maritime Offshore GmbH (EMO)

SOLUTIONS FROM A SINGLE SOURCE

OFFSHORE SERVICE LOGISTICS

EMO provides all required maritime services related to the construction and the maintenance of an offshore wind farm, from a single source.

Our Services are structured within three main sectors:

>> MARITIME SERVICES

- CREW TRANSFER, GUARD & SAFETY VESSELS
- SHIP MANAGEMENT
- CHARTER MANAGEMENT
- COORDINATION SERVICES
 - » AUDITS & SURVEYS
 - » HSE COORDINATION
 - » CONSULTING
- EMS MARITIME OFFSHORE CREWING

>> TECHNICAL & ENGINEERING SERVICES

- TECHNICAL MANAGEMENT
- PROJECT MANAGEMENT
- SUPERVISION OF NEW- AND REBUILDING
- DESIGN & CONSULTING

>> PORT & LOGISTICS SERVICES

- OWN PORT INFRASTRUCTURE
- STORAGE AND WAREHOUSING
- AGENCY SERVICES
- LOCATION ADVICE & PROJECT MANAGEMENT
- TRANSPORT ON- AND OFFSHORE
- FULL SUPPLY CHAIN MANAGEMENT
- CARGO AND SUPPLY RUNS

Due to our experiences in guard duties, crew transfers, marine coordination and on-/offshore logistics we can offer you services which are able to match all requirements of your project.

To match national and international standards, the *EMO* is certified according [ISO 9001](#), [ISO 14001](#) and [OHSAS 18001](#).